

**CALL FOR MORE INFORMATION**



**FOR GROUND LEASE**

100% LEASED

**PROPERTY HIGHLIGHTS**

- Join Albuquerque's first Raising Cane's!
- Walmart Supercenter outparcel with over 408k shoppers per year
- Co-Tenants include Chick-fil-A, Dollar Tree & Krispy Kreme
- Over 35,000 cars per day on Wyoming Blvd and located directly at the signalized hard corner

**TRAFFIC COUNT**

Wyoming Blvd: 35,700 VPD  
(STDB 2022)  
Menaul Blvd: 37,437 VPD  
(CoStar 2020)

**AREA TRAFFIC GENERATORS**



**PROPERTY SNAPSHOT**



**149,080**  
2021 POPULATION  
3 MILE RADIUS



**130,683**  
2021 DAYTIME POPULATION  
3 MILE RADIUS



**\$64,662**  
2021 AVERAGE INCOME  
3 MILE RADIUS



**35,700 VPD**  
WYOMING BLVD



**Anchored!**

Est. Visitors for Walmart Supercenter  
**408.4K Annually\***  
(\*Source: Placer.ai  
Jan 1st, 2021 - Dec 31st, 2021)



**1st Raising Cane's in NM  
Comming soon!**

The information contained herein was obtained from sources deemed reliable; however, RESOLUT RE makes no guaranties, warranties or representations to the completeness or accuracy thereof. The presentation of this real estate information is subject to errors; omissions; change of price; prior sale or lease; or withdrawal without notice. RESOLUT RE, which provides real estate brokerage services, is a division of Reliance Retail, LLC, a Texas Limited Liability Company.

Austin Tidwell, CCIM  
[atidwell@resolutre.com](mailto:atidwell@resolutre.com)  
505.337.0777

Daniel Kearney  
[dkearney@resolutre.com](mailto:dkearney@resolutre.com)

Rob Powell, CCIM  
[rpowell@resolutre.com](mailto:rpowell@resolutre.com)  
[www.resolutre.com](http://www.resolutre.com)

# Walmart Outparcel at Wyoming Mall

NEC WYOMING BLVD & NORTHEASTERN BLVD  
2004 WYOMING BOULEVARD NORTHEAST  
ALBUQUERQUE, NM 87112

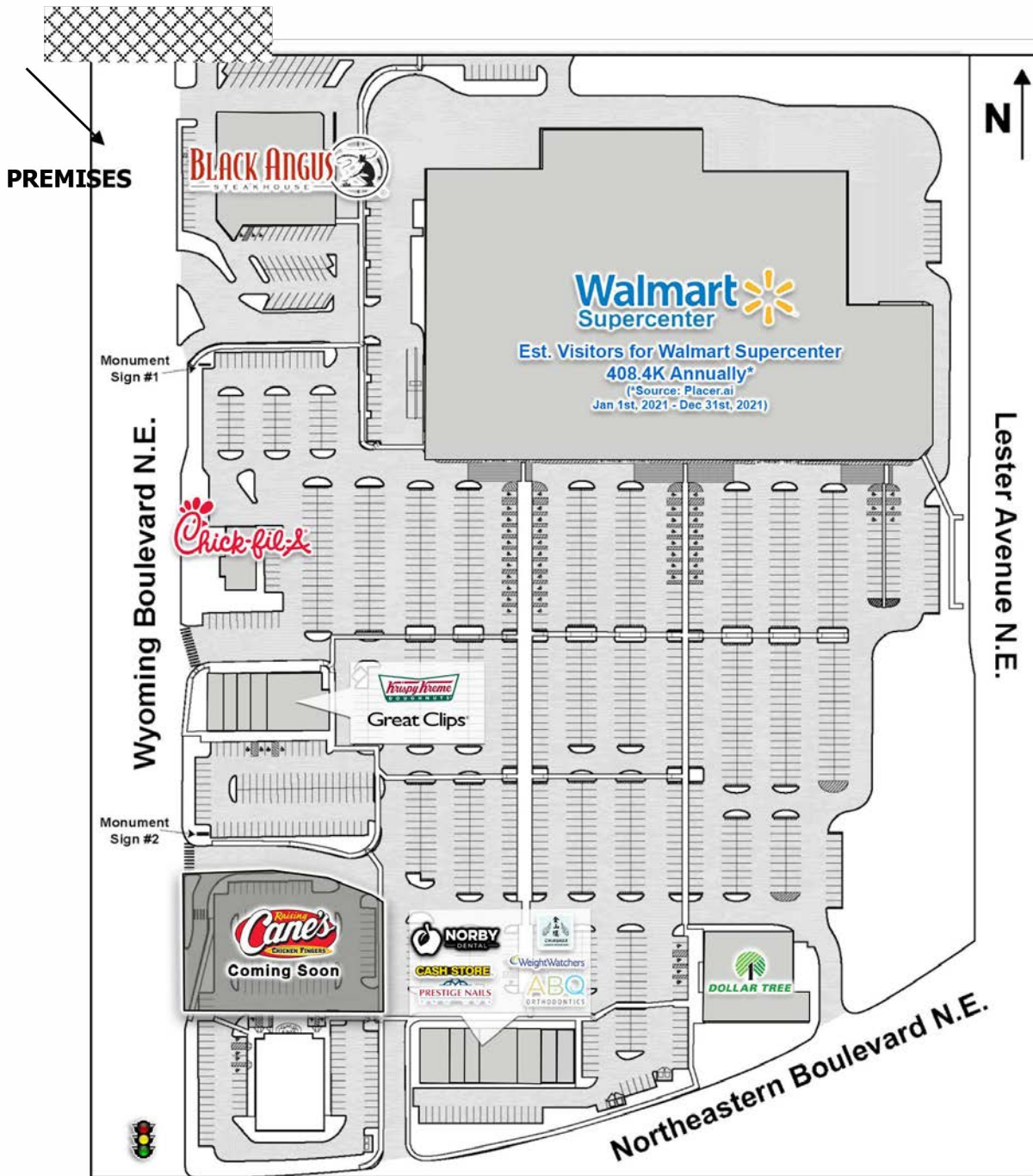

Austin Tidwell, CCIM  
atidwell@resolutre.com  
505.337.0777

Daniel Kearney  
dkearney@resolutre.com

Rob Powell, CCIM  
rpowell@resolutre.com  
www.resolutre.com



The information contained herein was obtained from sources deemed reliable; however, RESOLUT RE makes no guaranties, warranties or representations to the completeness or accuracy thereof. The presentation of this real estate information is subject to errors; omissions; change of price; prior sale or lease; or withdrawal without notice. RESOLUT RE, which provides real estate brokerage services, is a division of Reliance Retail, LLC, a Texas Limited Liability Company.

# Walmart Outparcel at Wyoming Mall

NEC WYOMING BLVD & NORTHEASTERN BLVD  
2004 WYOMING BOULEVARD NORTHEAST  
ALBUQUERQUE, NM 87112

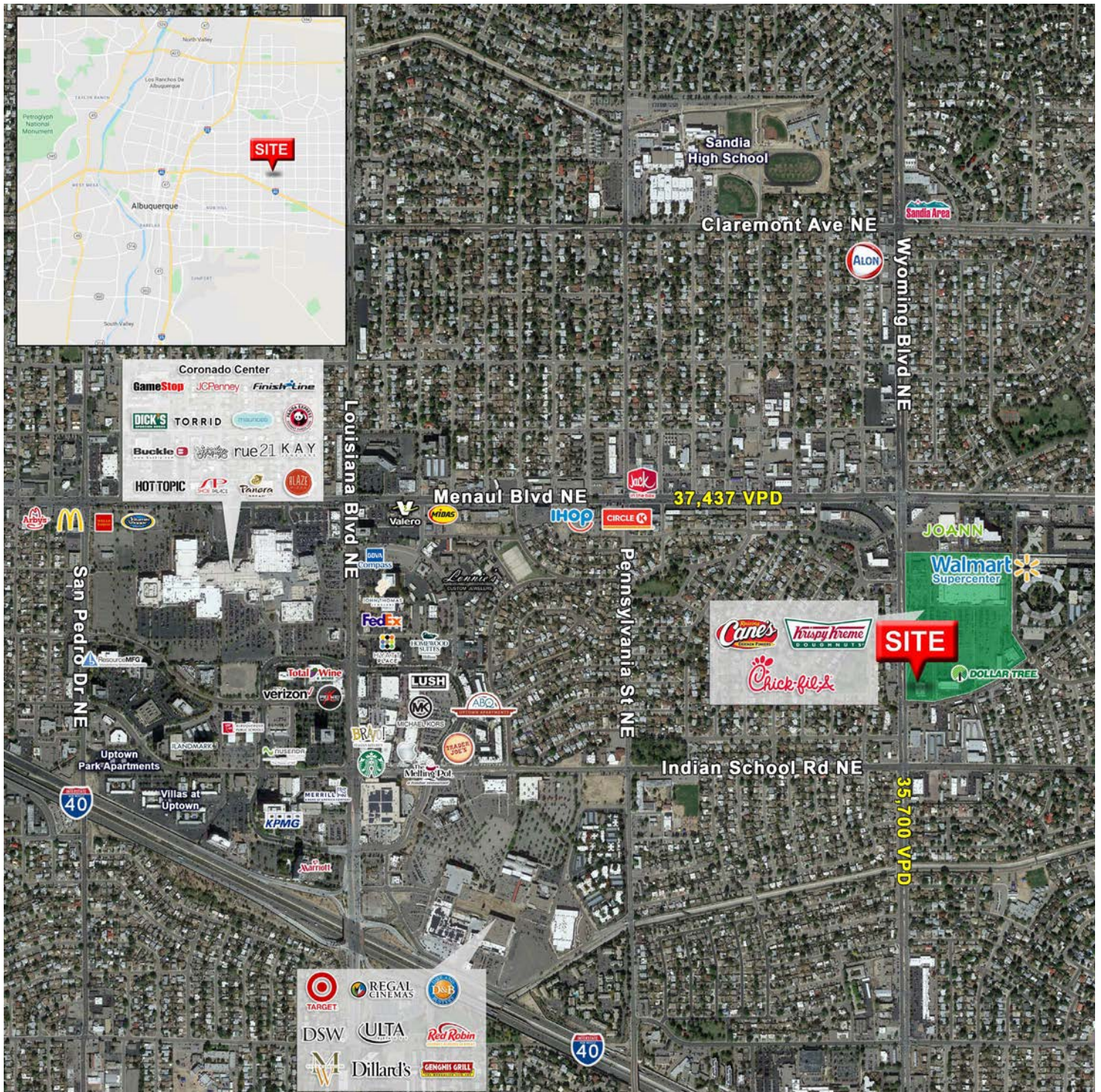

Austin Tidwell, CCIM  
[atidwell@resolutre.com](mailto:atidwell@resolutre.com)  
 505.337.0777

Daniel Kearney  
[dkearney@resolutre.com](mailto:dkearney@resolutre.com)

Rob Powell, CCIM  
[rpowell@resolutre.com](mailto:rpowell@resolutre.com)  
[www.resolutre.com](http://www.resolutre.com)



The information contained herein was obtained from sources deemed reliable; however, RESOLUT RE makes no guarantees, warranties or representations to the completeness or accuracy thereof. The presentation of this real estate information is subject to errors; omissions; change of price; prior sale or lease; or withdrawal without notice. RESOLUT RE, which provides real estate brokerage services, is a division of Reliance Retail, LLC, a Texas Limited Liability Company.

## Metrics

	Visitors	Visits	Visits / sq.ft	Visit frequency
Walmart / Wyoming Blvd Ne	408.4K	2.2M	10.49	5.39

## Walmart Supercenter - Trade Area - Home Location

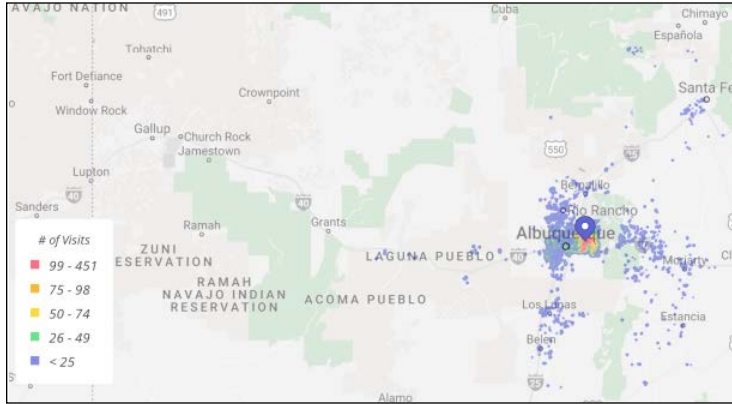

## Walmart Supercenter - Customer Journey Routes - Prior Location

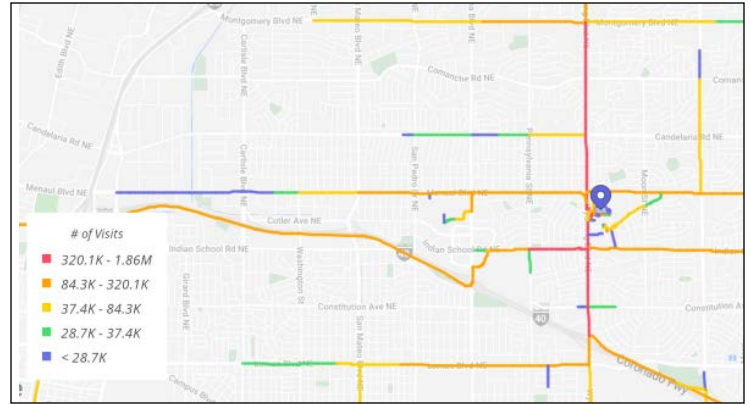

## Walmart Supercenter - Hourly Visits

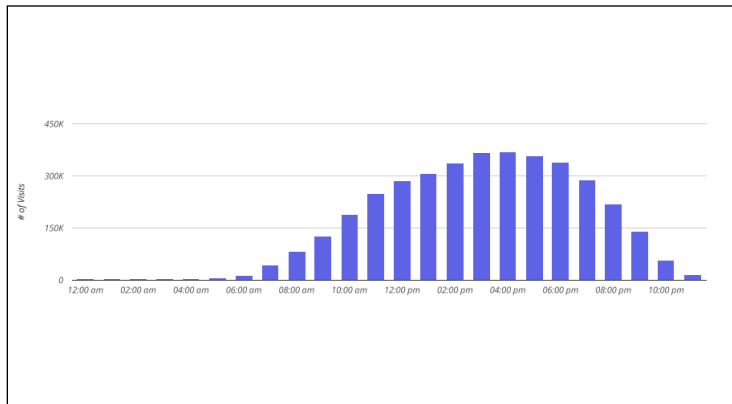

## Walmart Supercenter - Daily Visits

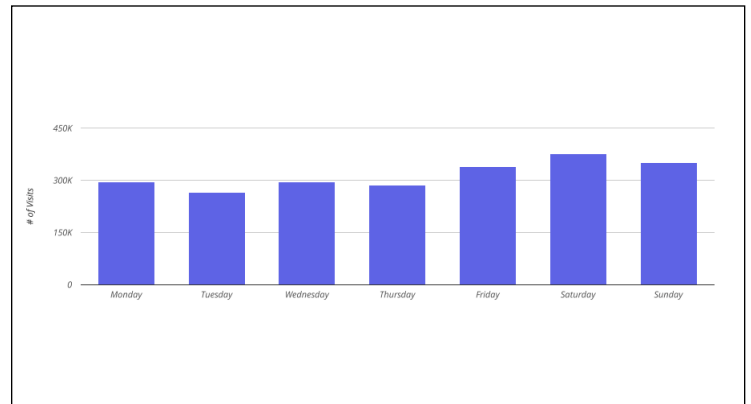

Jan 1, 2021 - Dec 31, 2021  
Data provided by Placer Labs Inc. ([www.placer.ai](http://www.placer.ai))



Austin Tidwell, CCIM  
[atidwell@resolutre.com](mailto:atidwell@resolutre.com)  
505.337.0777

Daniel Kearney  
[dkearney@resolutre.com](mailto:dkearney@resolutre.com)

Rob Powell, CCIM  
[rpowell@resolutre.com](mailto:rpowell@resolutre.com)  
[www.resolutre.com](http://www.resolutre.com)



The information contained herein was obtained from sources deemed reliable; however, RESOLUT RE makes no guaranties, warranties or representations to the completeness or accuracy thereof. The presentation of this real estate information is subject to errors; omissions; change of price; prior sale or lease; or withdrawal without notice. RESOLUT RE, which provides real estate brokerage services, is a division of Reliance Retail, LLC, a Texas Limited Liability Company.